

0 1/6 1/3 1/2 MILE
SCALE OF INSET

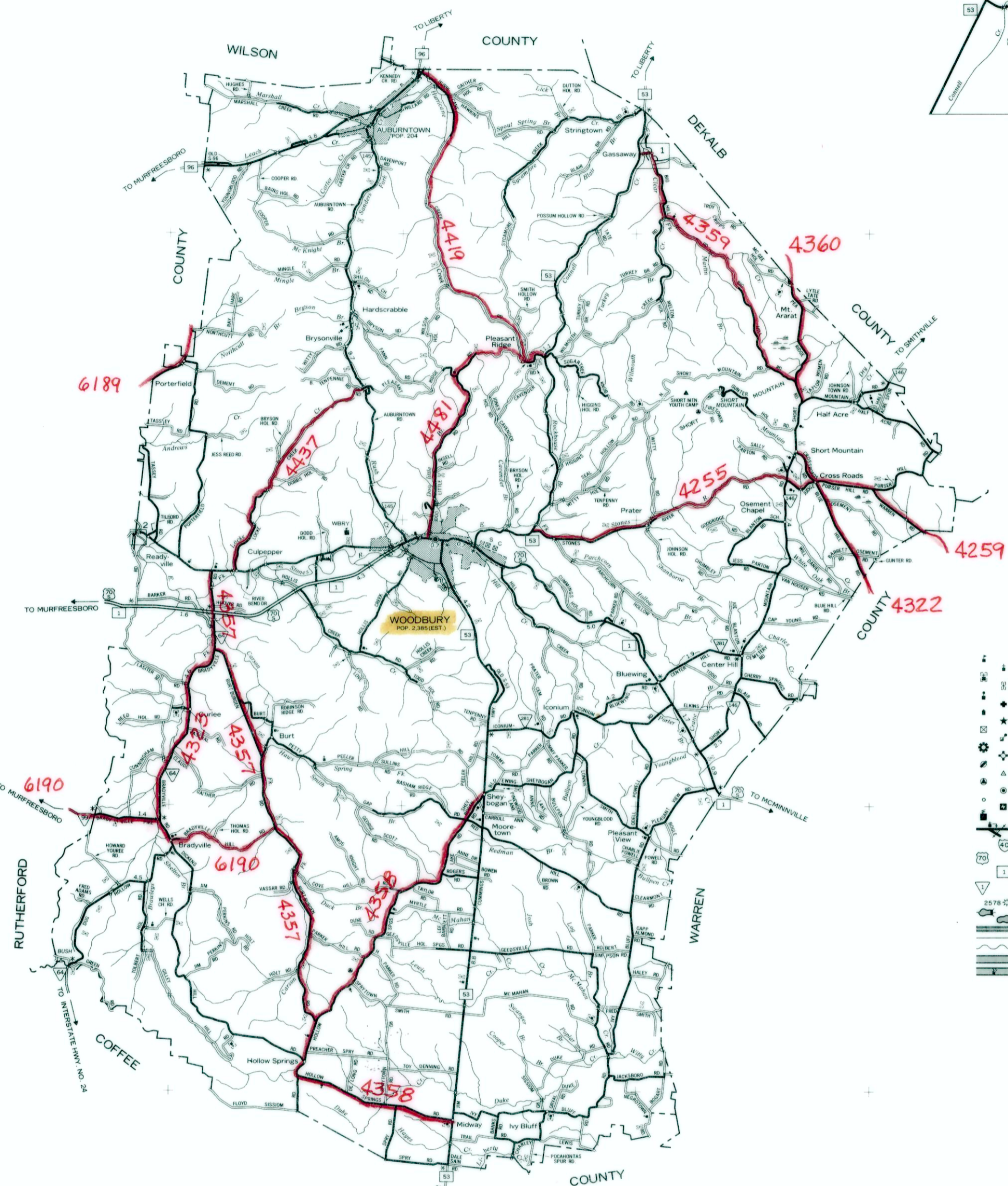
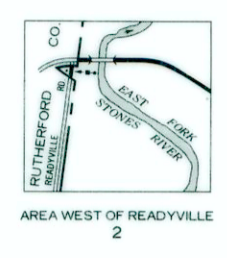
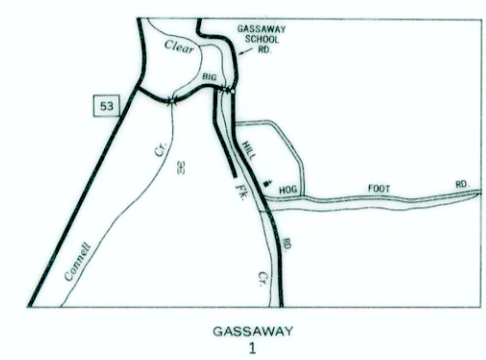

LEGEND

- SCHOOL
- CHURCH
- CHURCH WITH CEMETERY
- CEMETERY
- POST OFFICE
- HOSPITAL
- TOWN HALL OR COMMUNITY CENTER
- HIGHWAY PATROL STATION
- HIGHWAY GARAGE (S-STATE, C-COUNTY)
- WEIGHT STATION
- AIRPORT - COMPLETE FACILITIES
- AIRPORT - LIMITED FACILITIES
- LANDING AREA OR STRIP
- TRIANGULATION STATION
- OBSERVATION OR LOOKOUT TOWER
- COUNTY SEAT
- OTHER CITIES AND VILLAGES
- POWER PLANT
- RADIO OR TELEVISION STATION
- DOT TO INDICATE LOCATION OF ANY CULTURAL FEATURE OUT OF PLACE
- INTERSTATE HIGHWAY MARKER
- U.S. NUMBERED HIGHWAY MARKER
- STATE HIGHWAY MARKER (FEDERAL AID PRIMARY SYSTEM)
- STATE HIGHWAY MARKER (FEDERAL AID SECONDARY SYSTEM)
- PROMINENT PEAK WITH ELEVATION
- LAKE WITH DAM
- RESERVOIR, POND OR LAKE
- LEVEE OR DYKE
- DRAINAGE CANAL
- NARROW STREAM
- WIDE STREAM
- DAM WITH LOCK
- RAILROAD STATION
- GRADE CROSSING
- UNDERPASS ROAD BELOW
- OVERHEAD ROAD ABOVE
- RAILROAD TUNNEL
- HIGHWAY GRADE SEPARATION
- HIGHWAY BRIDGE OVER 20 FEET
- FORD
- LOW WATER BRIDGE
- FREE FERRY OR TOLL FERRY
- HIGHWAY BRIDGE LONG RIVER CROSSING (C-CONCRETE, S-STEEL, W-WOOD)
- PRIMITIVE OR UNIMPROVED ROAD
- GRADED AND DRAINED, SOIL, GRAVEL OR STONE SURFACED ROAD
- PAVED ROAD
- DIVIDED HIGHWAY
- 0.7 MILE DISTANCE IN MILES BETWEEN DESIGNATED POINTS
- (FCA) FULL CONTROL OF ACCESS
- (NPS) NATIONAL PARK SERVICE HIGHWAY
- HIGHWAY INTERCHANGE
- COUNTY LINE
- STATE LINE
- MONUMENTED BOUNDARY MARKER
- INCORPORATED CITY BOUNDARY
- RESERVATION BOUNDARY

FEDERAL AID SECONDARY ROUTES SHOWN IN RED ARE BASED ON SYSTEM ROUTE INFORMATION CIRCA 1976, THE YEAR THE PROGRAM ENDED.

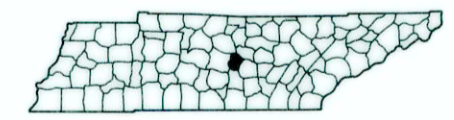

GENERAL HIGHWAY MAP CANNON COUNTY TENNESSEE

PREPARED BY THE
TENNESSEE DEPARTMENT OF TRANSPORTATION
BUREAU OF PLANNING AND DEVELOPMENT
PLANNING DIVISION
IN COOPERATION WITH THE
U.S. DEPARTMENT OF TRANSPORTATION
FEDERAL HIGHWAY ADMINISTRATION

SCALE
0 1 2 3 4 MILES

1991

MAP RECORD	
FIELD DATA OBTAINED IN 1980	
FIELD EXAMINATION MADE IN 1987	
REVISIONS	
FEATURE	DATE
COUNTY ROADNAMES REVISED	1988
STATE HIGHWAY NUMBER 145 REVISED	1988
STATE HIGHWAY SYSTEM	1991

1 COUNTY MAP SHEET WITH
2 SUPPLEMENTAL CITY MAP SHEETS
AUBURNTOWN
WOODBURY

POPULATION OF CANNON COUNTY
10,467 (1990 CENSUS)

POLYCONIC PROJECTION

AUTHORIZATION NO. 401901910800